

Let's Connect Via Our healow App
Get started in 3 simple steps!



1. Download
the free iOS or
Android app

GIBABD

2. Search for
our practice
using code:
GIBABD



3. Login with
your portal
credentials
given by our
practice

CrescentCare
A Partnership for Life



1 Download the healow App:

From your phone, go to the **App Store** (iPhone) or **Google Play** (Android)

Find and download the healow App.

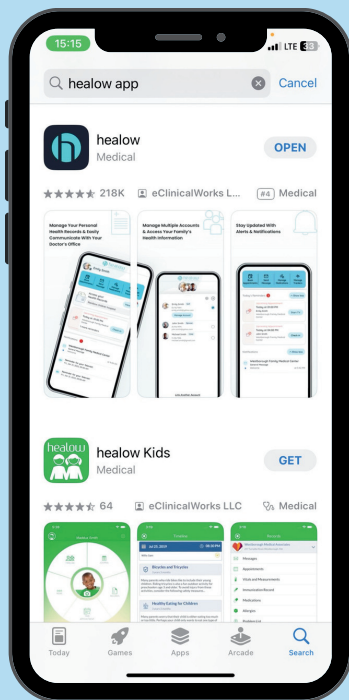

2 Healow notifications

Open app after installation is complete. Choose to either "Allow" and "Don't Allow" Notifications from Healow. A second pop-up window regarding allowing location when using app will appear later.

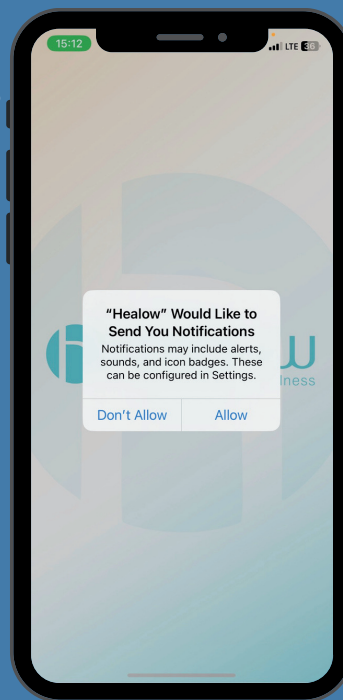

3 Get Started

Click get started to set up your profile on the app.



4 Terms of Use

Read the Terms of Use Agreement and click "I agree..."

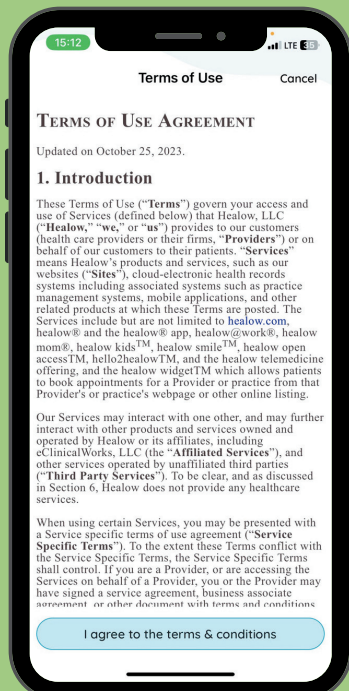

5 Patient Details

Enter your first and last name, along with your date of birth, to allow the system to locate your profile.

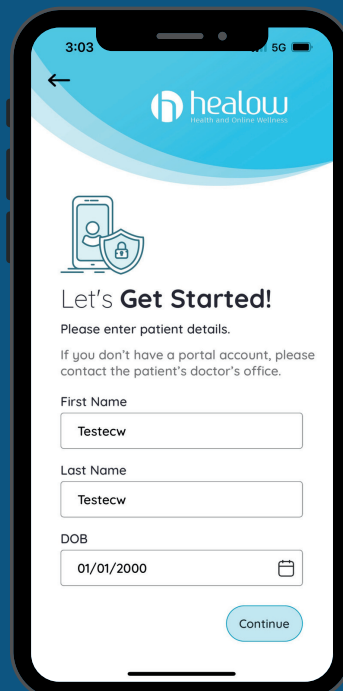

6 Choosing Practice Code

Select "Yes, I have Practice Code" option.

On the following screen, be prepared to enter our Practice Code: GIBABD

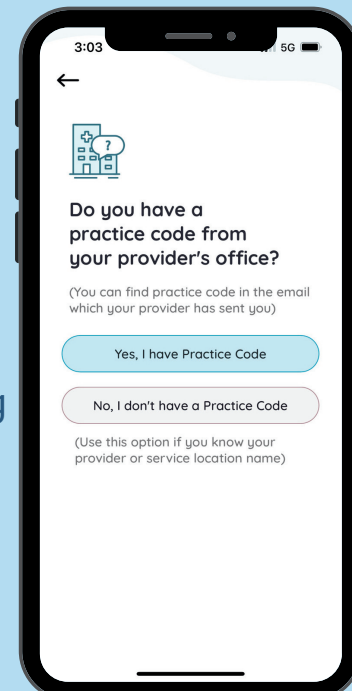



1. Download the free iOS or Android app

GIBABD

2. Search for our practice using code: GIBABD



3. Login with your portal credentials given by our practice



7 Practice Code

Enter the code **GIBABD** and click "Next" to verify that CrescentCare is the medical practice you attend.

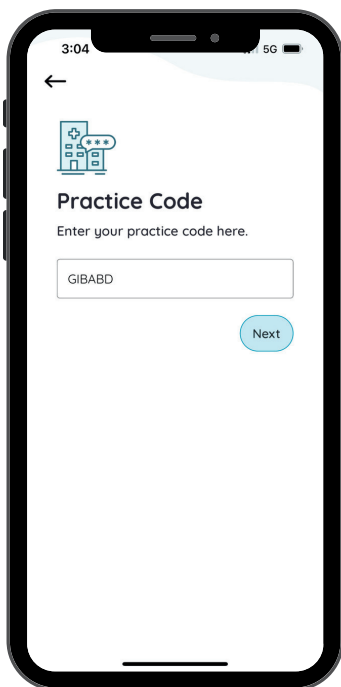

8 Verify Practice

Verify that CrescentCare is your medical practice by selecting the 'This is My Practice' button.

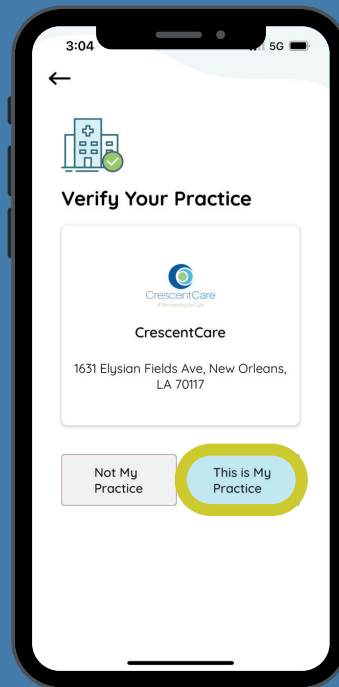

9 Account Verification

Verify your account with the phone number associated by inputting the code sent. Alternatively, you can verify with a username and password.

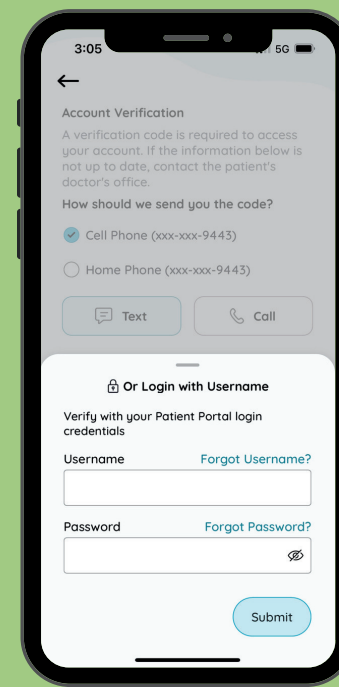

10 Create A PIN Code

Create a six-digit PIN code of your choice that will be used to unlock the app.

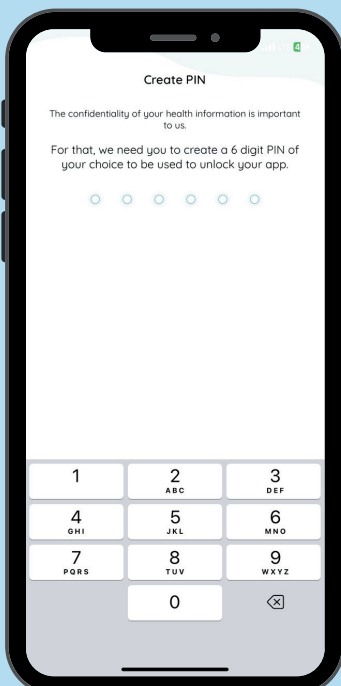

11 Welcome to the healow App.

You can view your patient information in Healow through two ways:

Information Wheel:

- Accessible through the wheel icon.
- Displays health information in a circular format.
- Offers a comprehensive overview of various health aspects.

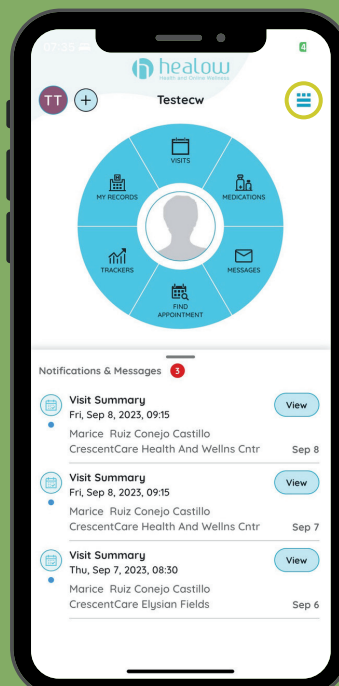

12 Welcome to the healow App.

You can view your patient information in Healow through two ways:

Information Bar:

- Accessed by selecting the icon in the top right.
- Presents specific health sections in a bar format.
- Allows users to switch to a different interface for detailed information in specific health categories.

